

FOX

PÖTTINGER Seedbed preparation



Clever seedbed preparation

FOX / FOX D



Our newly developed FOX and FOX D compact combinations deliver smooth-running, fuel-saving seedbed preparation. Combined with PÖTTINGER seed drills, this implement becomes a cost-effective 3-point-mounted mulch drill combo.

Your advantages at a glance

- Low drag resistance, fuel-saving seedbed preparation
- High working speed
- Short and compact design for optimum centre of gravity
- Compact combination with harrow tines (FOX) or discs (FOX D)
- Mulch drill combination with PÖTTINGER seed drills

Low drag resistance saves fuel

During the development of the PÖTTINGER short combinations, great attention was paid to compact dimensions and low drag resistance. This allows the use of smaller tractors and provides both a fuel-efficient and effective seedbed preparation.

Easy to adjust

The short headstock offers 3 positions on the extendable lower linkage arms. This enables the addition of frontal tools. There are also two top link positions to simplify the adjustment to fit any tractor to fit any tractor.

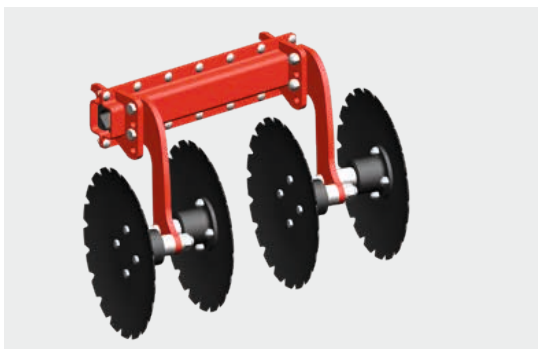

FOX disc tool

With the FOX D the discs take over the preparation of the soil. These are mounted on rubber elements and are depth adjustable for use in slightly stony soils. The discs have a diameter of 16" / 410 mm and are mounted on maintenance-free bearings.

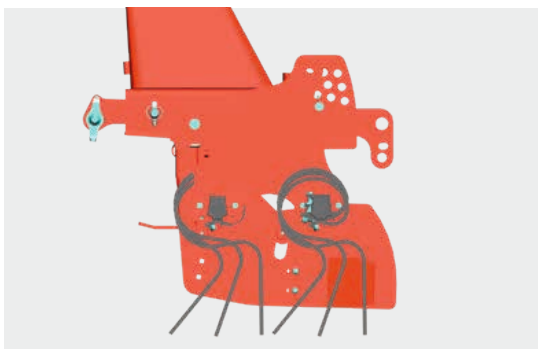

FOX harrow tines

The FOX is equipped with 2 rows of harrow tines for a finely-crumbled seedbed. The tines can be adjusted in 3 positions and are particularly suitable for light to medium soils and low levels of crop residues.

Fast sowing

In combination with a PÖTTINGER seed drill, this implement becomes a cost-effective 3-point-mounted seed drill combo. The drill is mounted either on the packer roller or on the hitch.

| FOX | Working width | Transport width | Tools | Tool spacing | Working depth | Minimum power |
|-----------|----------------|-----------------|-------|----------------|----------------------------|----------------|
| FOX 300 | 9.84' / 3,0 m | 9.84' / 3,0 m | 19 | 6.10" / 155 mm | 1.18" - 3.15" / 30 – 80 mm | 55 kW / 75 hp |
| FOX 350 | 11.48' / 3.5 m | 11.48' / 3.5 m | 23 | 6.10" / 155 mm | 1.18" - 3.15" / 30 – 80 mm | 66 kW / 90 hp |
| FOX 400 | 13.12' / 4.0 m | 13.12' / 4.0 m | 25 | 6.10" / 155 mm | 1.18" - 3.15" / 30 – 80 mm | 74 kW / 100 hp |
| FOX 300 D | 9.84' / 3.0 m | 9.84' / 3.0 m | 22 | 5.11" / 130 mm | 1.18" - 3.15" / 30 – 80 mm | 55 kW / 75 hp |
| FOX 350 D | 11.48' / 3.5 m | 11.48' / 3.5 m | 26 | 5.11" / 130 mm | 1.18" - 3.15" / 30 – 80 mm | 66 kW / 90 hp |
| FOX 400 D | 13.12' / 4.0 m | 13.12' / 4.0 m | 30 | 5.11" / 130 mm | 1.18" - 3.15" / 30 – 80 mm | 74 kW / 100 hp |



The wider alternative

FOX 350 / FOX 400

The lightweight mounted machine is ideal for use in light to medium soils with low levels of harvest residues. Thanks to its capability to be combined with a seed drill, the FOX compact combination is a real multi-talent. The result is a cost-effective mulch drilling combination.



High output compact combinations

- More productivity with wider working widths
- FOX 350 with 11.84 ft / 3.5 m working width
- FOX 400 with 13.12 ft / 4 m working width



| | Working transport width ft / m | Tines | Tine spacing inch / mm | Working depth inch / mm | Power requirement from |
|---------|-----------------------------------|-------|---------------------------|----------------------------|---------------------------|
| FOX 350 | 11.84 / 3.5 | 23 | 6.10 / 155 | 1.18 – 3.14 / 30 – 80 | 66 kW / 90 hp |
| FOX 400 | 13.12 / 4.0 | 25 | 6.10 / 155 | 1.18 – 3.14 / 30 – 80 | 74 kW / 100 hp |



Versatile applications

- Solo for mixing harvest residues into the soil
- Combined with a PÖTTINGER seed drill to form a cost-effective seed drill combination.
- Can be combined with VITASEM, VITASEM A and AEROSEM

| | Working, transport width ft / m | Discs | Disc spacing inch / mm | Working depth inch / mm | Power requirement from |
|-----------|------------------------------------|-------|---------------------------|----------------------------|---------------------------|
| FOX 350 D | 311.84 / 3.5 | 26 | 5.11 / 130 | 1.18 – 3.14 / 30 – 80 | 66 kW / 90 hp |
| FOX 400 D | 13.12 / 4.0 | 30 | 5.11 / 130 | 1.18 – 3.14 / 30 – 80 | 74 kW / 100 hp |

D = disc



Rear rollers for LION

PÖTTINGER offers a wide range of rear rollers for perfect results with the desired tilth in any type of soil. The whole range of rollers features precision manufacturing and robust design engineering.

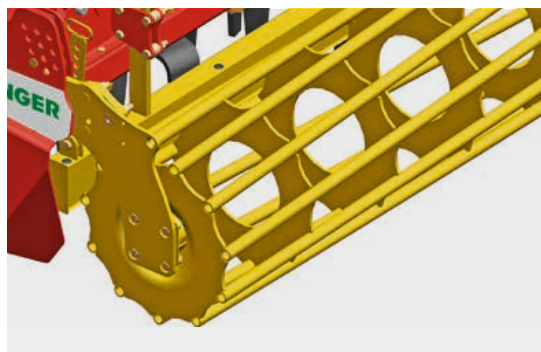

Cage roller

The ideal roller for dealing with dry, non-sticky soils.

The roller is fitted with strong bars for optimal consolidation.

Diameter: 16.5 inch / 420 mm, eight bars

Diameter: 21.3 inch / 540 mm, eleven bars

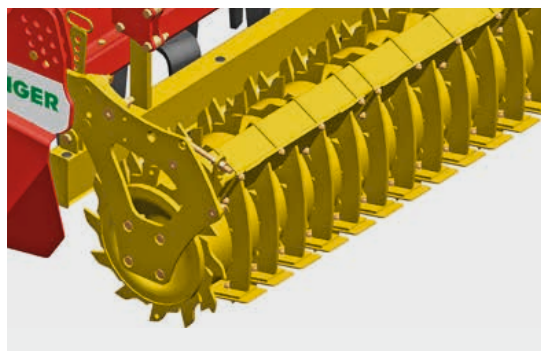

Tooth-packer roller

This all-rounder is suitable for all types of soil. The roller leaves behind an optimum, re-consolidated seedbed with loose, fine soil at seed level. The scrapers are located just above surface level. This ensures no clods can be lifted away, even in wet conditions ensuring a perfect capillary structure remains intact for optimum germination. The packer teeth are completely hardened and coated scrapers are available as an option.

Diameter: 16.5, 19.7 and 21.7 inch / 420, 500 and 550 mm

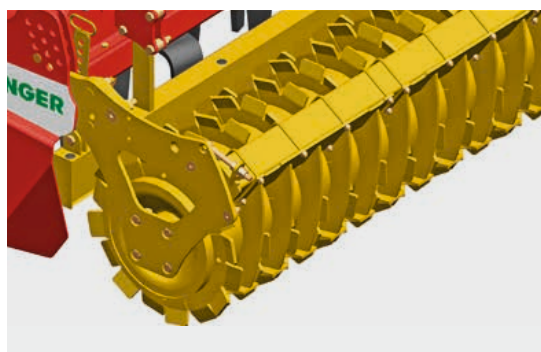

Crumbling packer roller

The packer teeth are offset at an angle to the left and right. This roller is especially suitable for heavy, clay soils. The result is a deep consolidation effect with loose crumbling effect just under the surface. Coated scrapers are standard and help prevent soil sticking to the roller.

Diameter: 20.7 inch / 525 mm

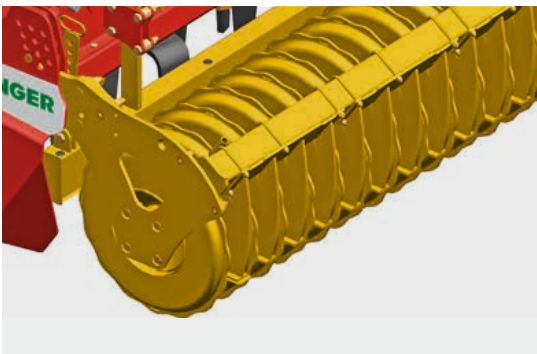

Pack Ring roller

The packer rings are completely enclosed and have a diameter of 21.7 inch / 550 mm with eight rings per metre of working width. The roller produces a corrugated consolidation effect to promote water absorption and allow the soil to breathe. Ideal for stony, damp conditions and heavy organic residues. Harvest residues remain on the surface of the soil and protect the soil against drying. Coated scrapers are standard and help prevent soil sticking to the roller.

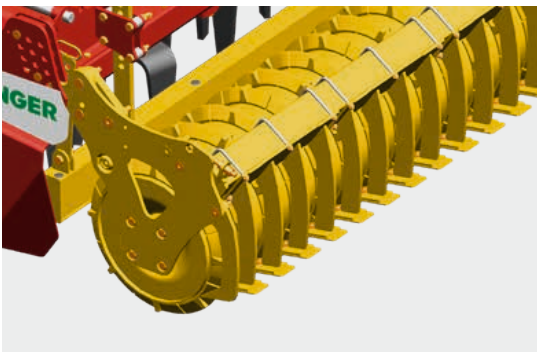

Prism-packer roller

The Prism rings are spaced at 4.92 inch / 12.5 mm or 5.9 inch / 150 mm. This roller handles all operating conditions, including stony ground and larger quantities of harvest trash. The striped formation of re-consolidation promotes water absorption and breathability of the soil that is subject to less compaction in the gap between the rings. Coated scrapers are standard and help prevent soil sticking to the roller. Diameter: 19.7 and 23.6 inch / 500 and 600 mm



Rubber packer roller

This roller is ideal for widely varying ground conditions. A diameter of 23 inch / 585 mm combined with the special profiling allows the soil to be compacted in rows. Coated scrapers are standard and help prevent soil sticking to the roller.



Your machine goes online.

All the information on your machine
easily – anytime – anywhere

Simply scan the QR code on the **data plate** with your smartphone or tablet or enter your machine number at www.poettinger.at/poetpro. You will immediately receive all the information on your machine.

- Operating instructions
- Optional equipment information
- Brochures
- Photos and videos



PÖTTINGER Spare parts service

- Worldwide network of sales and service partners.
- Decades of spare and wear parts availability.
- Original PÖTTINGER parts can be ordered online around the clock.

PÖTTINGER Landtechnik GmbH

Industriegelände 1
4710 Grieskirchen
Austria
Phone +43 7248 600-0
info@poettinger.at
www.poettinger.at

Alois PÖTTINGER UK Ltd.

15 St Marks Road, Corby
Northamptonshire,
NN18 8AN
United Kingdom
Phone + 44 1536 272 220
info@pottingeruk.co.uk
www.pottingeruk.co.uk

POETTINGER Canada Inc.

460 Rue Robinson Sud
Granby, QC, J2G 7N6
Canada
Phone +1 450 372 5595
Fax +1 866 417 1683
info@poettinger.ca
www.poettinger.ca

POETTINGER US, Inc.

393 Pilot Drive
Valparaiso, IN 46383
USA
Phone +1 219 510 5534
Fax + 1 219 707 5412
info@poettinger.us
www.poettinger.us

PÖTTINGER Australia PTY LTD

11 Efficient Drive
Truganina VIC 3029
Australia
Phone +61 3 8353 2770
info@poettinger.com.au
www.poettinger.com.au

POETTINGER Ireland Ltd.

Glenaleamy, Powerstown Road,
Clonmel, Co. Tipperary
Ireland
Phone +353 52 6125766
info@poettinger.ie
www.poettinger.ie

Importer for New Zealand:

Origin Agroup
PO Box 673, 57 Hautapu Road
Cambridge
New Zealand
Phone +64 7 823 7582
info@originagroup.co.nz
www.originagroup.co.nz

Importer for South Africa:

VALTRAC
Cnr. Water & Buiten Street
9585 Parys
South Africa
Phone +27 56 817 7338 7308
wynn@valtrac.co.za
www.valtrac.co.za

